

SIZE	A	B	C	PART NUMBER
3/4 x 1/2	0.620	0.370	1.25	A3114MPIS-.75x.5-PX-31dL
1 x 1/2	0.870	0.370	1.25	A3114MPIS-1x.5-PX-31dL
1 x 3/4	0.870	0.370	1.25	A3114MPIS-1x.75-PX-31dL
1-1/2 x 1/2	1.370	0.370	1.25	A3114MPIS-1.5x.5-PX-31dL
1-1/2 x 3/4	1.370	0.620	1.25	A3114MPIS-1.5x.75-PX-31dL
1-1/2 x 1	1.370	0.870	1.25	A3114MPIS-1.5x1-PX-31dL
2 x 1/2	1.870	0.370	1.25	A3114MPIS-2x.5-PX-31dL
2 x 3/4	1.870	0.620	1.25	A3114MPIS-2x.75-PX-31dL
2 x 1	1.870	0.870	1.25	A3114MPIS-2x1-PX-31dL
2 x 1-1/2	1.870	1.370	1.25	A3114MPIS-2x1.5-PX-31dL
2-1/2 x 1/2	2.370	0.370	1.25	A3114MPIS-2.5x.5-PX-31dL
2-1/2 x 3/4	2.370	0.620	1.25	A3114MPIS-2.5x.75-PX-31dL
2-1/2 x 1	2.370	0.870	1.25	A3114MPIS-2.5x1-PX-31dL
2-1/2 x 1-1/2	2.370	1.370	1.25	A3114MPIS-2.5x1.5-PX-31dL
2-1/2 x 2	2.370	1.870	1.25	A3114MPIS-2.5x2-PX-31dL
3 x 1/2	2.870	0.370	1.25	A3114MPIS-3x.5-PX-31dL
3 x 3/4	2.870	0.620	1.25	A3114MPIS-3x.75-PX-31dL
3 x 1	2.870	0.870	1.25	A3114MPIS-3x1-PX-31dL
3 x 1-1/2	2.870	1.370	1.25	A3114MPIS-3x1.5-PX-31dL
3 x 2	2.870	1.870	1.25	A3114MPIS-3x2-PX-31dL
3 x 2-1/2	2.870	2.370	1.25	A3114MPIS-3x2.5-PX-31dL
4 x 3/4	2.000	0.620	1.25	A3114MPIS-4x.75-PX-31dL
4 x 1	3.834	0.870	1.25	A3114MPIS-4x1-PX-31dL
4 x 1-1/2	3.834	1.370	1.25	A3114MPIS-4x1.5-PX-31dL
4 x 2	3.834	1.870	1.25	A3114MPIS-4x2-PX-31dL
4 x 2-1/2	3.834	2.370	1.25	A3114MPIS-4x2.5-PX-31dL
4 x 3	3.834	2.870	1.25	A3114MPIS-4x3-PX-31dL

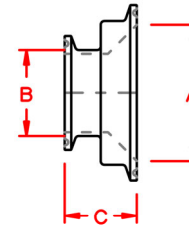

			Tolerances: (Except as Noted)
			Fractional: ± 1/32
			Decimal: .x = .015 .xx = .010 .xxx = .005
			Angular: ± 1/2°
Rev	Date	Rev Description	

ADVANCE FITTINGS <small>corp.</small>	
P 262-723-6599 F 262-723-6643 www.advancefittings.com	
Title CONICAL INSTRUMENT REDUCER	
Drawing No. A3114MPIS CHARTED	Rev No. -
Drawn By: E.T.	Date: 1/25/23
Scale: NA	Customer Name: